

# Window locking handles

## Multipoint and Single Point



We are proud to introduce our innovative new line of premium locking handles:

- Standard LTS
- Contemporary
- Colonial

Available in standard powder-coated zinc alloy.





## 2340 Series

### Colonial Features

- Versatile and elegant handle design
- Progressive locking mechanism
- Heavy duty gear mechanism
- Optional sealing gasket

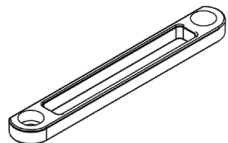

Composite backer plate

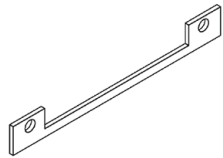
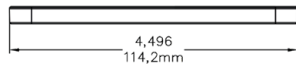
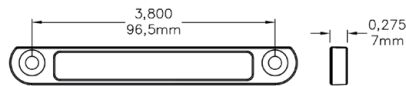

Metal backer plate

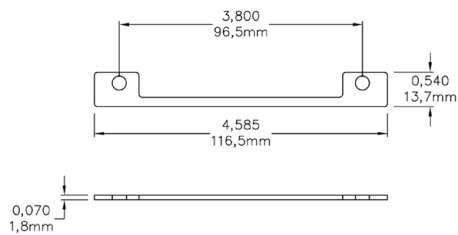

Recommended screw :

8-32 Phillips truss head

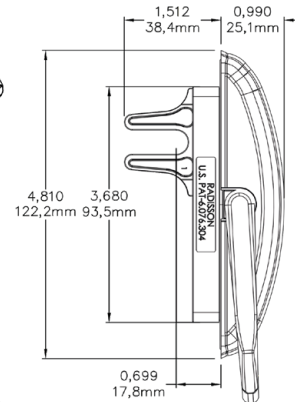
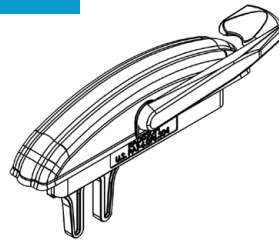

Multipoint handle

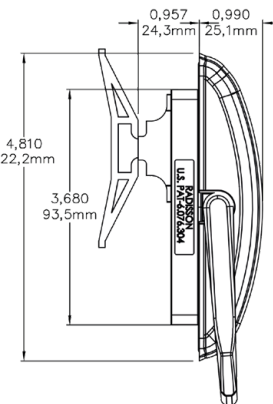
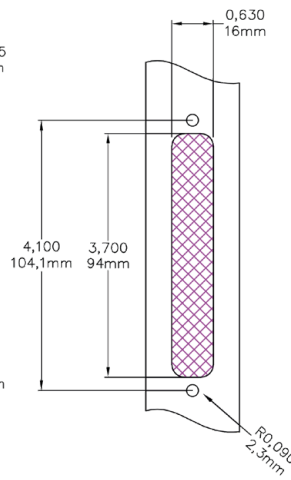
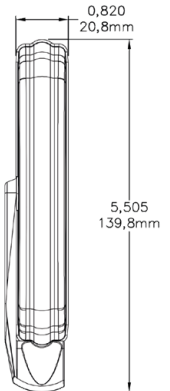

Single point handle

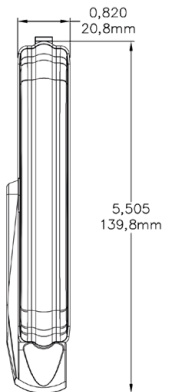

## Colors and finishes



The perception of colors by the human eye varies from one individual to another. Colors and finishes shown below are for illustrative purposes only and should be used solely for general guidance.

**Actual colors and finishes may vary depending on the shape of the product, its composition, and the brightness of the light to which it is exposed. Contact a Radisson Industries representative for an actual sample and stock availability.**

### Powder-Coated Finishes

179 Blue White	101 Cocoa Brown	087 Gold Tone	114 Sandstone	FB Faux Oil Rubbed	300 West Coast White
152 Euro White	112 Bronze	105 Clay	122 Sahara Beige	310 West Coast Beige	131 Black
185 White	113 Chestnutt Bronze	119 Silver	191 Beige	161 Coppertone	

### Decorative Finishes

117 Satin Nickel	118 Antique Brass	120 Bright Brass
135 Polished Chrome	210 Brushed Silver	200 Brushed Nickel
	115 Brushed Chrome	

## Ordering information

*\*The company has an ongoing development program and therefore reserves the right to make alterations without notice. Products that are not stocked items will be subject to longer lead times. Please confirm with your Radisson representative.*

### Locking Handles

Part Number	Description	Box/Qty.	Replace the variable <b>X</b> with the desired value to specify handle type: <b>Blank</b> = Multipoint locking handle <b>A</b> = Optional single point locking handle (Awning application)
PO- <b>X</b> 2501- <b>YYY</b>	Multipoint or Single point Standard locking handle	50	
PO- <b>X</b> 3000- <b>YYY</b>	Multipoint or Single point Contemporary locking handle	50	
PO- <b>X</b> 2340- <b>YYY</b>	Multipoint or Single point Colonial locking handle	50	Replace the variable <b>YYY</b> with the desired value to specify colors or finishes.

### Accessories

Part Number	Description	Box/Qty.
PO-BP-2401-00	Flat metal backer plate for locking handle	500
PO-BP-2401-01	Offset metal backer plate for locking handle	500
PO-BP-3000-00	Flat composite backer plate for locking handle	500

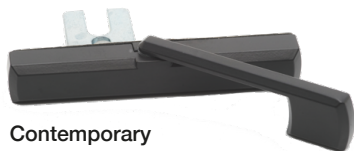

## Contact us

# RADISSON INDUSTRIES

INNOVATIVE COMPONENTS  
www.radissonindustries.com

136, Rue Leon-Vachon  
St-Lambert-de-Lauzon  
Quebec, G0S 2W0  
CANADA

**Toll Free :**

**1-866-889-9032**

Ph: 1-418-889-9032

Fax: 1-418-889-0103

General Inquiries :

[info@industriesradisson.com](mailto:info@industriesradisson.com)

Purchase Orders:

[intlorders@industriesradisson.com](mailto:intlorders@industriesradisson.com)

## Maintenance

We strongly recommend performing hardware maintenance at least once a year or more depending on need. Regular cleaning and lubrication of these items will prolong component life and keep them working properly.

### Cleaning

For optimal corrosion resistance, always keep the surfaces clean. This can be achieved by wiping them with a damp clean cloth using either a very mild detergent or soap, then rinsing with warm, clean water to avoid soap residue build-up and drying with a soft cloth.

Do NOT use abrasive, chemical, acidic or citrus-based cleaners, gasoline, wire brushes, scrubbers, and wire wool. They can permanently alter or damage surfaces or hardware finishes.

### Lubrication

Because of their sealing properties, petroleum-based lubricant sprays (e.g., WD-40 ) are highly recommended for lubricating functioning hardware.



### LIFETIME WARRANTY

\*\*Our products are warranted against all manufacturing defects and malfunctions of the material used during fabrication.

\*\* Failure to ensure proper maintenance in accordance with the above instructions will invalidate the replacement warranty. Does not cover normal wear and tear, discoloration, rust, or any other alteration of the finishes. This warranty will not be honored if the product is not used or maintained properly or if it has been modified or improperly installed.