

COTÉ GAUCHE / LEFT HAND

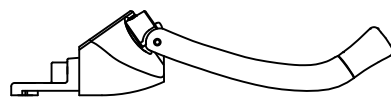

DESCRIPTION	# PRODUIT /PART #	DIM A
LTS Single Arm Operator 7.5" , LH	OP-10621G	7.5"
LTS Single Arm Operator 7.5" , RH	OP-10621D	7.5"
LTS Single Arm Operator 9.5" , LH	OP-10622G	9.5"
LTS Single Arm Operator 9.5" , RH	OP-10622D	9.5"
LTS Single Arm Operator 13.5" , LH	OP-10623G	13.5"
LTS Single Arm Operator 13.5" , RH	OP-10623D	13.5"

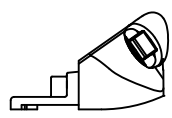
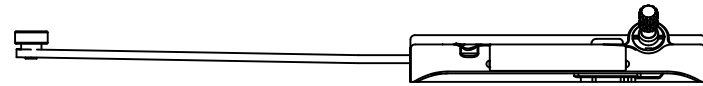
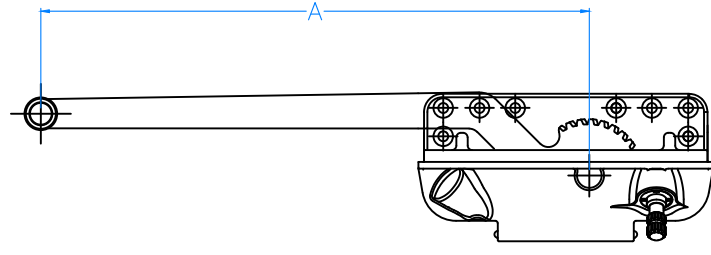
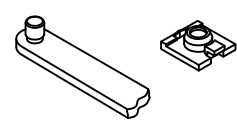

Plastic Slider

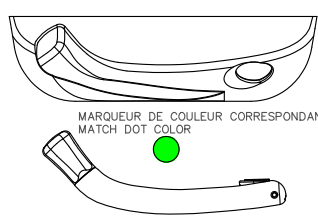

MARQUEUR DE COULEUR CORRESPONDANT/
MATCH DOT COLOR

VIS RECOMMANDÉ / RECOMMENDED SCREW: BOIS / WOOD 10-12 UNDERCUT TÊTE / HEAD #7 . LONGEUR À ÊTRE DÉTERMINÉE / LENGTH TO BE DETERMINED

DATE / DATE : 07-01-2016 / 01-07-2016	REVISION :	DESCRIPTION : OPÉRATEUR BRAS DROIT LTS
# PRODUIT / PART # :	# ACIER INOX / PART # SS : OP-10621G-SS	DESCRIPTION : LTS STRAIGHT ARM OPERATOR
QUANT. BOITE / BOX QTY : 20	POIDS UNITAIRE / UNIT WEIGHT : 1.350 LBS	